

DATA SHEET

FOR RIVETS FOR SOFT MATERIALS

ALUMINIUM/STEEL

Rivet: Aluminium AlMg 3.5
Mandrel: steel zincplated

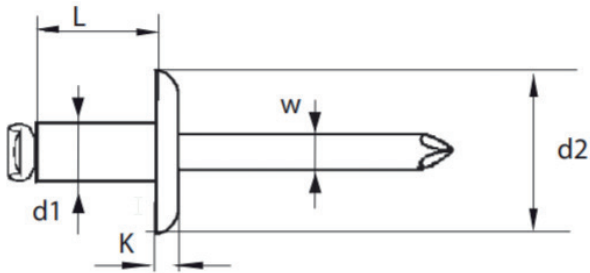

d1 = diameter of rivet
L = length of rivet
d2 = diameter of head
K = height of head
w = diameter of mandrel
E = grip length

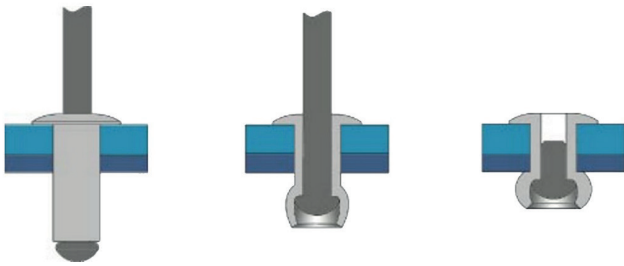

d1	L	d2	K	w	E	Art.-Nr.
4.8	12.0	9.5	1.4	2.73	6.0 - 8.0	55944812
	14.0				8.0 - 10.0	55944814
	16.0				10.0 - 12.0	55944816
	18.0				12.0 - 14.0	55944818
	21.0				14.0 - 17.0	55944821
	24.0				17.0 - 20.0	55944824

specifications in mm

Load capacity of the assembly for sheering strain/ tensile strain:

4,0: 2.000N / 2.700N

DATENBLATT

FÜR NIETEN FÜR WEICHE MATERIALIEN ALUMINIUM/STAHL

Niete: Aluminium Al Mg 3,5
Nietdorn: Stahl, verzinkt A1K

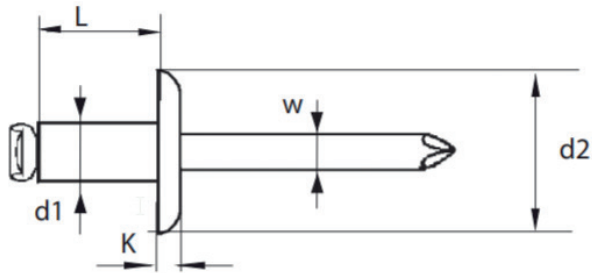

d1 = Durchmesser der Niete
L = Länge der Niete
d2 = Durchmesser des Nietkopfs
K = Höhe des Nietkopfs
W = Durchmesser des Dorns
E = möglicher Klemmbereich

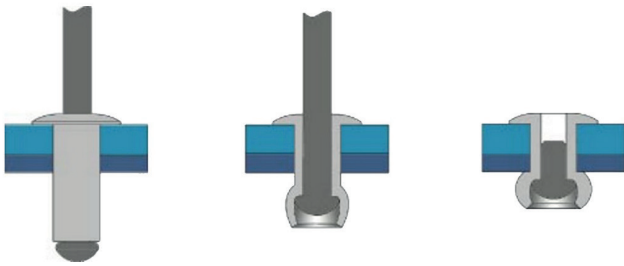

d1	L	d2	K	w	E	Art.-Nr.
4,8	12,0	9,5	1,4	2,73	6,0 - 8,0	55944812
	14,0				8,0 - 10,0	55944814
	16,0				10,0 - 12,0	55944816
	18,0				12,0 - 14,0	55944818
	21,0				14,0 - 17,0	55944821
	24,0				17,0 - 20,0	55944824

Angaben in mm

Belastbarkeit der Nietverbindung auf Scherung / Zug:
4,0: 2.000N / 2.700N