

DATA SHEET

FOR GROOVED FLAT-HEAD RIVETS MADE OF ALUMINUM/STEEL

Rivet: Aluminium AlMg 3.5
Mandrel: steel zincplated

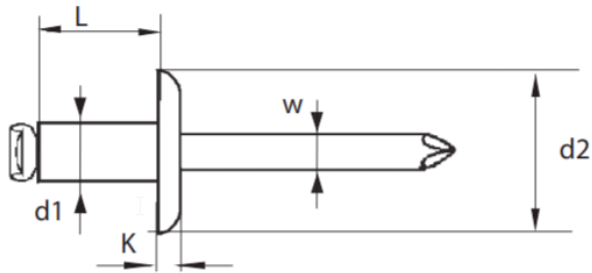

d1 = diameter of rivet
L = length of rivet
d2 = diameter of head
K = height of head
w = diameter of mandrel
E = grip length

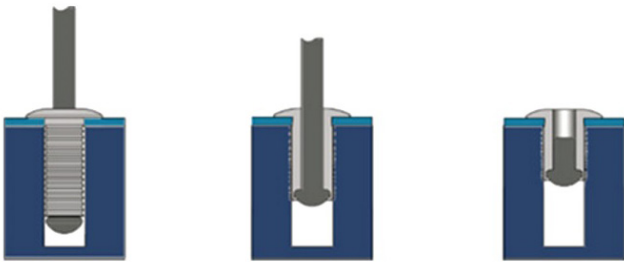

d1	L	d2	K	w	E	Art.-Nr.
3.2	10	6.5	0.8	1.8	6.0	5596
4	16	8	1.20	2.20	4.0	55964016
4.8	12	9.5	1.40	2.65	8.0	55964812
4.8	18	9.5	1.40	2.65	13.0	55964818

specifications in mm

Load capacity of the assembly for sheering strain/ tensile strain:

3.2: 700N / 1100N
4.0: 900N / 1400N
4.8: 1600N / 2600N

DATENBLATT

FÜR GERILLTE FLACHRUNDKOPF- NIETEN AUS ALUMINIUM/STAHL

Niete: Aluminium Al Mg 3,5
Nietdorn: Stahl, verzinkt A1K

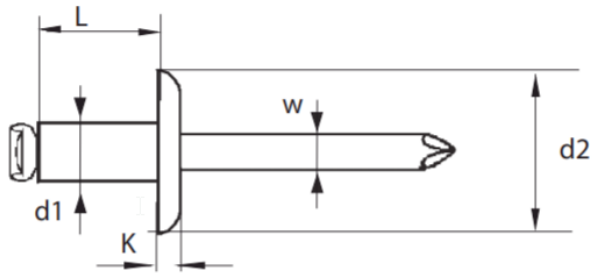

d1 = Durchmesser der Niete
L = Länge der Niete
d2 = Durchmesser des Nietkopfs
K = Höhe des Nietkopfs
W = Durchmesser des Dorns
E = möglicher Klemmbereich

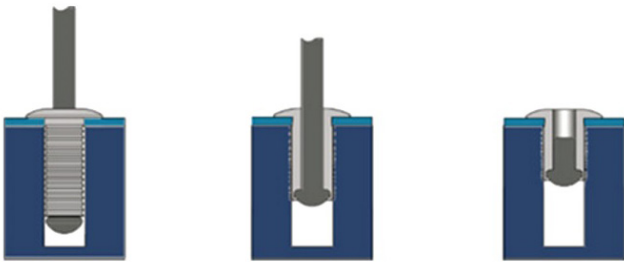

d1	L	d2	K	w	E	Art.-Nr.
3.2	10	6.5	0.8	1.8	6.0	5596
4	16	8	1.20	2.20	4.0	55964016
4.8	12	9.5	1.40	2.65	8.0	55964812
4.8	18	9.5	1.40	2.65	13.0	55964818

Angaben in mm

Belastbarkeit der Nietverbindung auf Scherung / Zug:

3.2: 700N / 1100N
4.0: 900N / 1400N
4.8: 1600N / 2600N